

Interlocking concrete tiles laid on sw battens on sarking felt on prefabricated timber trusses fixed to timber frame structure. 300mm mineral wool quilt insulation laid between and over ceiling joists. 25mm eaves vents to be provided to soffits to provide cross flow ventilation to roof space

Black half round pvc rainwater goods installed to upvc fascia boarding with 25mm continuous soffit vents installed to soffit boarding

Lean to roof constructed from interlocking concrete tiles on battens and felt on 125x50mm rafters @400mm c/c fixed to 175x50mm timber wall plate bolted to external wall with M10 bolts @600mm c/c and to 100x50mm wall plate strapped to inner leaf with builders straps. Painted timber T&G boarding fixed to underside of rafters to form ceiling of porch

75mm sand and cement screed over 500 gauge separating layer of building paper on 100mm Celotex GA4000 floor insulation over 1200 gauge polythene DPM lapped to DPC on Beam and Block suspended floor system with 225mm ventilated sub floor void with concrete over site and vented with telescopic ventilators. 25mm perimeter insulation to be provided at edge of slab and screed.

Piled foundations with ground beams in accordance with Engineers design and details

## SECTION AA NTS

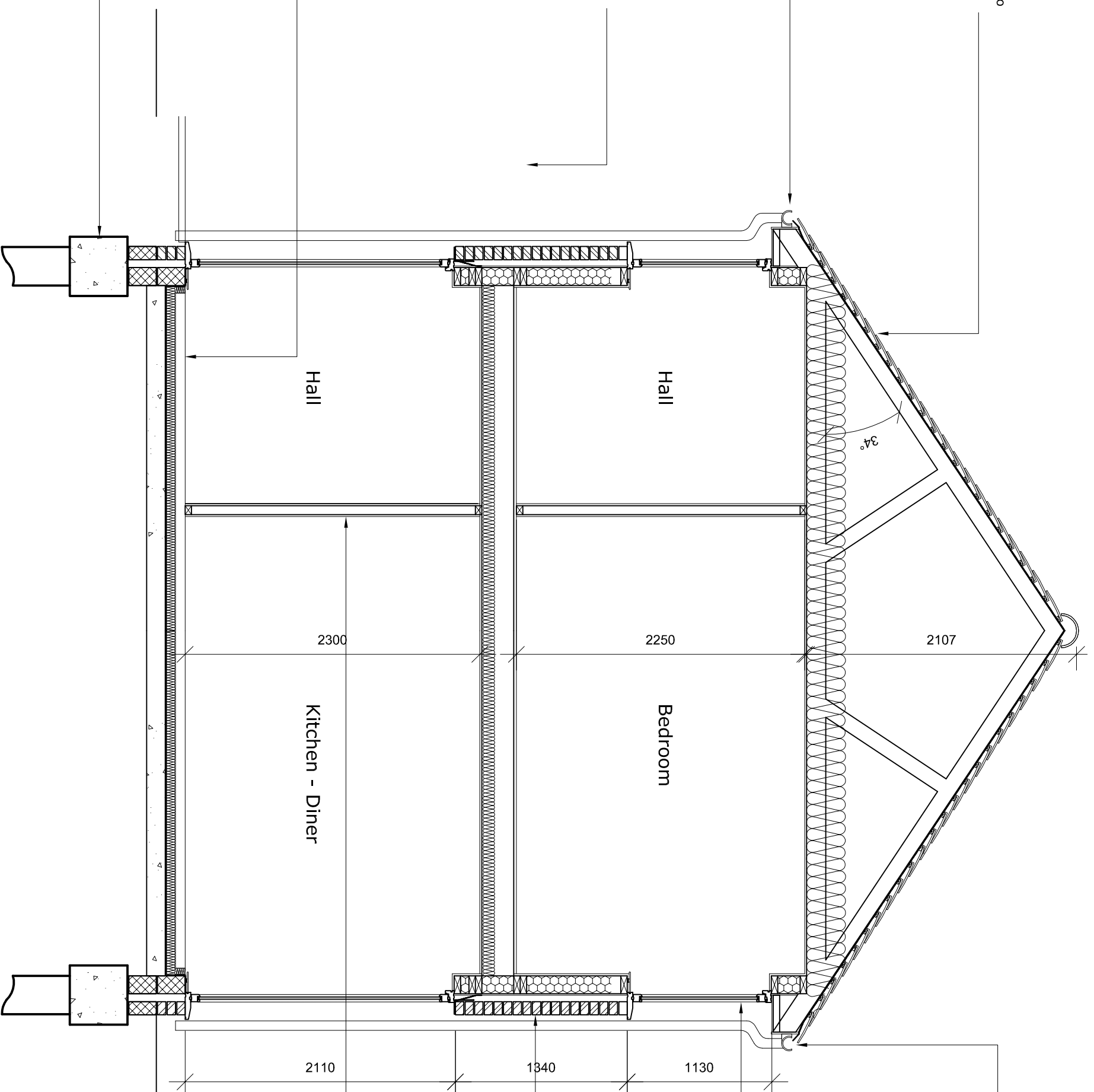

Black half round pvc rainwater goods installed to upvc fascia boarding with 25mm continuous soffit vents installed to soffit boarding

New double glazed windows and doors installed with min 'U' value of 1.6 W/m<sup>2</sup>K

Facing brick external leaf with 50mm clear cavity ties to timber frame structure - all to specialist suppliers design and detail consisting of timber sheathing boarding fixed over fully filled 140mm insulated timber stud frame ensuring continuous vapour control layer fixed to internal face and finished in plasterboard, tape and jointed or Gypsum skim finish (ensure brickwork is constructed with slip joints tolerances as required for timber frame structure)

New partition walls to be timber studwork min 70mm studs with in 25mm mineral wool insulation with one layer of 12.5mm wallboard 10 or similar to achieve a mass of 10kg/m<sup>2</sup> either side with lightweight gypsum skim finish to achieve 43db type E1 wall.

Rev Date By Note

**BUILDING REGS**

Project	17 THE RYDINGS
WINDSOR	
SL4 4HF	
Title	PROPOSED DWELLINGS
	SECTION AA
Drawing Number	1320/BR09
Date	JUN'16
Drawn	GP
Scale	As Stated
Paper	A3

1: 20  
1: 200  
1: 100

2 m  
20 m  
10 m

1: 50  
1: 500  
1: 1250

5 m  
50 m  
125 m

**artichoke** : architectural consultancy

71 Clewer Hill Road - Windsor - SL4 4DE  
t: 01753 830 422 - m: 07793 318 035  
chris.dale@artichoke-design.co.uk

